

I HYDRAULIC FITTINGS		
BUN	NO SKIVE FERRULE FOR SAE 100 R1/2T – DIN EN 853 1/2SN	104
B1T	NO SKIVE FERRULE FOR SAE 100 R1T – DIN EN 853 1SN	104
B2T	NO SKIVE FERRULE FOR SAE 100 R2T – DIN EN 853 2SN	105
B12	NO SKIVE FERRULE FOR SAE 100 R1/2T – DIN EN 853 1/2SN	105
B1A	SKIVE FERRULE FOR SAE 100 R1A – DIN EN 853 1ST	106
B2A	SKIVE FERRULE FOR SAE 100 R2A – DIN EN 853 2ST	106
B4P	SKIVE FERRULE FOR SAE 100 R9R/R10/R12 – DIN EN 856 4SP	107
B4H	SKIVE FERRULE FOR DIN EN 856 4SH	107
B1C	NO SKIVE FERRULE FOR DIN EN 857 1SC	108
BR7	NO SKIVE FERRULE FOR SAE 100 R7/R8 – DIN EN 855	108
FG	BSP FEMALE, 60° CONE	109
PFG	BSP FEMALE THRUST WIRE NUT, 60° CONE	110
SFG	BSP FEMALE SLIP BACK NUT, 60° CONE	110
FSPG	BSP FEMALE FLAT FACE	111
C90G	BSP SWEPT 90° FEMALE, 60° CONE	112
PC90G	BSP SWEPT 90° FEMALE THRUST WIRE NUT, 60° CONE	113
SC90G	BSP SWEPT 90° FEMALE SLIP BACK NUT, 60° CONE	113
C90COMP G	BSP FEMALE 90° COMPACT ELBOW, 60° CONE	114
C45G	BSP SWEPT 45° FEMALE, 60° CONE	115
PC45G	BSP SWEPT 45° FEMALE THRUST WIRE NUT, 60° CONE	116
SC45G	BSP SWEPT 45° FEMALE SLIP BACK NUT, 60° CONE	116
OG	BSP BANJO	117
MG	BSPP MALE, 60° SEAT	118
MC	BSPT MALE, 60° SEAT	119
MNPT	NPTF MALE	120
FJ	JIC FEMALE, 37° SEAT	121

I HYDRAULIC FITTINGS		
PFJ	JIC FEMALE THRUST WIRE NUT, 37° SEAT	122
SFJ	JIC FEMALE SLIP BACK NUT, 37° SEAT	122
FJDE	JIC FEMALE DOUBLE HEXAGON, 37° SEAT	123
C90J	JIC SWEPT 90° FEMALE, 37° SEAT	124
PC90J	JIC SWEPT 90° FEMALE THRUST WIRE NUT, 37° SEAT	125
SC90J	JIC SWEPT 90° FEMALE SLIP BACK NUT, 37° SEAT	125
C90COMPJ	JIC FEMALE 90° COMPACT ELBOW, 37° SEAT	126
C45J	JIC SWEPT 45° FEMALE, 37° SEAT	127
PC45J	JIC SWEPT 45° FEMALE THRUST WIRE NUT, 37° SEAT	128
SC45J	JIC SWEPT 45° FEMALE SLIP BACK NUT, 37° SEAT	128
MJ	JIC MALE, 37° CONE	129
FEL	METRIC O-RING FEMALE, 24° CONE, DIN 3853 LIGHT	130
C90EL	METRIC SWEPT 90° O-RING FEMALE, 24° CONE, DIN 3865 LIGHT	131
C45EL	METRIC SWEPT 45° O-RING FEMALE, 24° CONE, DIN 3865 LIGHT	132
MEL	METRIC MALE, 24° SEAT, DIN 3853 LIGHT	133
FES	METRIC O-RING FEMALE, 24° CONE, DIN 3865 HEAVY	134
C90ES	METRIC SWEPT 90° O-RING FEMALE, 24° CONE, DIN 3865 HEAVY	135
C45ES	METRIC SWEPT 45° O-RING FEMALE, 24° CONE, DIN 3865 HEAVY	136
MES	METRIC MALE, 24° SEAT, DIN 3853 HEAVY	137
COD	METRIC STANDPIPE, DIN 2353	138
COD90	METRIC SWEPT 90° STANDPIPE, DIN 2353	139
COD45	METRIC SWEPT 45° STANDPIPE, DIN 2353	140
FM	METRIC FEMALE, 60° CONE	141
C90M	METRIC SWEPT 90° FEMALE, 60° CONE	142
C45M	METRIC SWEPT 45° FEMALE, 60° CONE	143
OM	METRIC BANJO	144

I HYDRAULIC FITTINGS		
MM	METRIC MALE, 60° SEAT	145
FLPI3	SAE FLANGE 3000 PSI - SAE J518	146
FLPI6	SAE FLANGE 6000 PSI - SAE J518	146
FLPI390	SAE FLANGE 3000 PSI SWEPT 90° - SAE J518	147
FLPI690	SAE FLANGE 6000 PSI SWEPT 90° - SAE J518	147
FLPI345	SAE FLANGE 3000 PSI SWEPT 45° - SAE J518	148
FLPI645	SAE FLANGE 6000 PSI SWEPT 45° - SAE J518	148
SEM3	SAE SPLIT FLANGE 3000 PSI - SAE J518	149
SEM6	SAE SPLIT FLANGE 6000 PSI - SAE J518	149
FLPIR6	SUPERCAT FLANGE	150
FLPIR690	SUPERCAT FLANGE SWEPT 90°	151
FLPIR645	SUPERCAT FLANGE SWEPT 45°	151
FORFS	ORFS FEMALE	152
MORFS	ORFS MALE	152
C90ORFS	ORFS SWEPT 90° FEMALE	153
C45ORFS	ORFS SWEPT 45° FEMALE	153
FW	CO2 FEMALE WHITWORTH THREAD	154
MW	CO2 MALE WHITWORTH THREAD	154
FMK	PRESSURE WASH FEMALE "K"	155
GPG	DOUBLE CONNECTOR	156
RS	WELDING INSERT	157

BUN

NO SKIVE FERRULE UNIFICATED FOR SAE 100 R1/2T - DIN EN 853 1/2SN

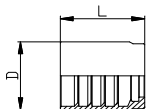

Artikelcode	Slangmaat		Snijlengte mm	Afmeting (mm)		Slangtype
	Inch	mm		D	L	
BUN04	1/4	6	NO	23	26	R1/2AT-1/2SN
BUN05	5/16	8	NO	24	26,2	R1/2AT-1/2SN
BUN06	3/8	10	NO	26	30,5	R1/2AT-1/2SN
BUN08	1/2	12	NO	29	32,5	R1/2AT-1/2SN
BUN10	5/8	16	NO	33	36	R1/2AT-1/2SN
BUN12	3/4	20	NO	37	39	R1/2AT-1/2SN
BUN16	1"	25	NO	46	44	R1/2AT-1/2SN
BUN20	1 1/4	32	NO	59	59	R1/2AT-1/2SN
BUN24	1 1/2	40	NO	67	67	R1/2AT-1/2SN
BUN32	2"	50	NO	80	72	R1/2AT-1/2SN

COMPATIBLE ALSO WITH 2SC-R2K

B1T

NO SKIVE FERRULE FOR SAE 100 R1T - DIN EN 853 1SN

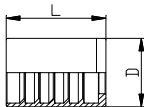

Artikelcode	Slangmaat		Snijlengte mm	Afmeting (mm)		Slangtype
	Inch	mm		D	L	
B1T03	3/16	5	NO	19	26	R1AT-1SN
B1T04	1/4	6	NO	20	30,5	R1AT-1SN
B1T05	5/16	8	NO	22	30,6	R1AT-1SN
B1T06	3/8	10	NO	24	31,5	R1AT-1SN
B1T08	1/2	12				
B1T10	5/8	16				
B1T12	3/4	20				
B1T16	1"	25	NO	43	50,2	R1AT-1SN
B1T20	1 1/4	32	NO	53	59	R1AT-1SN
B1T24	1 1/2	40	NO	60	73	R1AT-1SN
B1T32	2"	50	NO	78	78,5	R1AT-1SN

B2T

NO SKIVE FERRULE FOR SAE 100 R2T - DIN EN 853 2SN

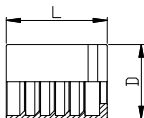

Artikelcode	Slangmaat		Snijlengte mm	Afmeting (mm)		Slangtype
	Inch	mm		D	L	
B2T03	3/16	5	NO	20	26,9	R2AT-2SN
B2T04	1/4	6	NO	22	30,5	R2AT-2SN
B2T05	5/16	8	NO	24	30,6	R2AT-2SN
B2T06	3/8	10	NO	25,5	31,5	R2AT-2SN
B2T08	1/2	12				
B2T10	5/8	16				
B2T12	3/4	20				
B2T16	1"	25	NO	46	50,2	R2AT-2SN
B2T20	1 1/4	32	NO	56	60	R2AT-2SN
B2T24	1 1/2	40	NO	64	72	R2AT-2SN
B2T32	2"	50	NO	80	80	R2AT-2SN

B12

NO SKIVE FERRULE UNIFICATED FOR SAE 100 R1/2T - DIN EN 853 1/2SN

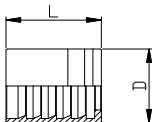

Artikelcode	Slangmaat		Snijlengte mm	Afmeting (mm)		Slangtype
	Inch	mm		D	L	
B1208	1/2	12	NO	29	34,3	R1/2AT-1/2SN
B1210	5/8	16	NO	32	37	R1/2AT-1/2SN
B1212	3/4	20	NO	36	42,3	R1/2AT-1/2SN

B1A

SKIVE FERRULE FOR SAE 100 R1A - DIN EN 853 1ST

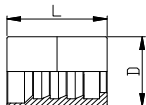

Artikelcode	Slangmaat		Snijlengte mm	Afmeting (mm)		Slangtype
	Inch	mm		D	L	
B1A03	3/16	5	16	18	26,6	R1A/1ST
B1A04	1/4	6	18,5	20	29,4	R1A/1ST
B1A05	5/16	8	18,5	22	29,5	R1A/1ST
B1A06	3/8	10	20	24	32	R1A/1ST
B1A08	1/2	12	22	29	34	R1A/1ST
B1A10	5/8	16	25	32	36,7	R1A/1ST
B1A12	3/4	20	30	36	42,6	R1A/1ST
B1A16	1"	25	36	43	50,2	R1A/1ST
B1A20	1 1/4	32	41	52	57,2	R1A/1ST
B1A24	1 1/2	40	43	57	63,1	R1A/1ST
B1A32	2"	50	60	70	78,1	R1A/1ST

B2A

SKIVE FERRULE FOR SAE 100 R2A - DIN EN 853 2ST

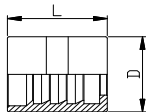

Artikelcode	Slangmaat		Snijlengte mm	Afmeting (mm)		Slangtype
	Inch	mm		D	L	
B2A03	3/16	5	16,5	20	27,2	R2A-2ST
B2A04	1/4	6	18,5	21	30,1	R2A-2ST
B2A05	5/16	8	18,5	24	30,1	R2A-2ST
B2A06	3/8	10	20	26	31,8	R2A-2ST
B2A08	1/2	12	22	30	33,9	R2A-2ST
B2A10	5/8	16	25	34	37,1	R2A-2ST
B2A12	3/4	20	30	38	42,6	R2A-2ST
B2A16	1"	25	36	46	50,2	R2A-2ST
B2A20	1 1/4	32	41	56	59,3	R2A-2ST
B2A24	1 1/2	40	43	62	63	R2A-2ST
B2A32	2"	50	60	75	79	R2A-2ST

B4P

SKIVE FERRULE FOR SAE 100 R9R/R10/R12 - DIN EN 856 4SP

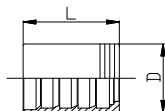

Artikelcode	Slangmaat		Snijlengte mm	Afmeting (mm)		Slangtype
	Inch	mm		D	L	
B4P04	1/4	6	19	22	30	R9R-4SP
B4P06	3/8	10	23	26	31,8	R9R-4SP
B4P08	1/2	12	23	30	34	R9R-4SP
B4P10	5/8	16	32	34	45	R9R-4SP
B4P12	3/4	20	37	38	51,8	R9R-4SP-4SH
B4P16	1"	25	43	46	60	R9R-4SP-4SH
B4P20	1 1/4	32	49	56	66,2	R10-4SP
B4P24	1 1/2	40	55,5	65	77	R10-4SP
B4P32	2"	50	58,5	80	80	R10-4SP

B4H

SKIVE FERRULE FOR DIN EN 856 4SH

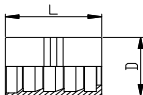

Artikelcode	Slangmaat		Snijlengte mm	Afmeting (mm)		Slangtype
	Inch	mm		D	L	
B4H20	1 1/4	32	51	52	66	4SH
B4H24	1 1/2	40	58	62	76,5	4SH
B4H32	2"	50	60	75	80	4SH

B1C

NO SKIVE FERRULE FOR DIN EN 857 1SC

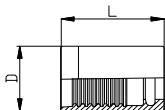

Artikelcode	Slangmaat		Snijlengte mm	Afmeting (mm)		Slangtype
	Inch	mm		D	L	
B1C04	1/4	6	NO	18	27	1SC
B1C05	5/16	8	NO	20	27	1SC
B1C06	3/8	10	NO	22	30,5	1SC
B1C08	1/2	12	NO	25	32,5	1SC
B1C10	5/8	16	NO	29	36	1SC
B1C12	3/4	20	NO			1SC
B1C16	1"	25	NO			1SC

BR7

NO SKIVE FERRULE FOR SAE 100 R7/R8 - DIN EN 855

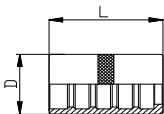

Artikelcode	Slangmaat		Snijlengte mm	Afmeting (mm)		Slangtype
	Inch/Pollici	mm		D	L	
BR703	3/16	5	NO	14	30	R7-R8
BR704	1/4	6	NO	17	29	R7-R8
BR705	5/16	8	NO	19	30	R7-R8
BR706	3/8	10	NO	22	31	R7-R8
BR708	1/2	12	NO	25,5	34	R7-R8
BR710	5/8	16	NO	29	37	R7-R8
BR712	3/4	20	NO	33	40,9	R7-R8
BR716	1"	25	NO	40	47,6	R7-R8

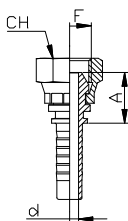
FG
BSP FEMALE, 60° CONE

Artikelcode	Draad F	Slangmaat		Afmeting (mm)		
		Inch	mm	CH	A	d
FG0203	1/8	3/16	5	15	16,8	3
FG0204	1/8	1/4	6	15	17	4
FG0403	1/4	3/16	5	19	18,6	3
FG0404	1/4	1/4	6	19	18,9	4
FG0405	1/4	5/16	8	19	18,9	5,5
FG0406	1/4	3/8	10	19	19	7
FG0604	3/8	1/4	6	22	20,1	4
FG0605	3/8	5/16	8	22	20,1	5,5
FG0606	3/8	3/8	10	22	20,2	7
FG0608	3/8	1/2	12	22	20,7	7
FG0805	1/2	5/16	8	27	22,3	5,5
FG0806	1/2	3/8	10	27	22,4	7
FG0808	1/2	1/2	12	27	22,9	9,5
FG0810	1/2	5/8	16	27	22,9	12
FG1008	5/8	1/2	12	28	22,9	9,5
FG1010	5/8	5/8	16	28	22,9	12
FG1208	3/4	1/2	12	32	25,4	9,5
FG1210	3/4	5/8	16	32	25,4	12
FG1212	3/4	3/4	20	32	25,6	15
FG1612	1"	3/4	20	38	26,3	15
FG1616	1"	1"	25	38	27,6	20
FG2016	1 1/4	1"	25	50	30	20
FG2020	1 1/4	1 1/4	32	50	30,6	26

PFG

BSP FEMALE THRUST WIRE NUT, 60° CONE

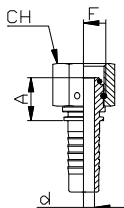

Artikelcode	Draad F	Slangmaat		Afmeting (mm)		
		Inch	mm	CH	A	d
PFG1210	3/4	5/8	16	32	25	12
PFG1212	3/4	3/4	20	32	26	15
PFG1612	1"	3/4	20	38	27	15
PFG1616	1"	1"	25	38	28	20
PFG2016	1 1/4	1"	25	50	30	20
PFG2020*	1 1/4	1 1/4	32	50	32	26
PFG2420*	1 1/2	1 1/4	32	55	34	26
PFG2424*	1 1/2	1 1/2	40	55	34,4	32
PFG3224*	2"	1 1/2	40	70	31	32
PFG3232*	2"	2"	50	70	31	44

* WITH O-RING - CON O-RING

SFG

BSP FEMALE SLIP BACK NUT, 60° CONE

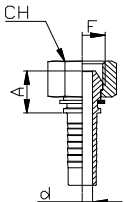

Artikelcode	Draad F	Slangmaat		Afmeting (mm)		
		Inch	mm	CH	A	d
SFG0404	1/4	1/4	6	19	18,9	4
SFG0604	3/8	1/4	6	22	20,1	4
SFG0605	3/8	5/16	8	22	20,1	5,5
SFG0606	3/8	3/8	10	22	20,2	7
SFG0806	1/2	3/8	10	27	22,4	7
SFG0808	1/2	1/2	12	27	22,9	9,5

FSPG

BSP FEMALE FLAT FACE

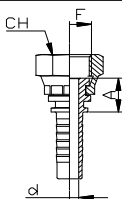

Artikelcode	Draad F	Slangmaat		Afmeting (mm)		
		Inch	mm	CH	A	d
FSPG0404	1/4	1/4	6	19	14,3	4
FSPG0606	3/8	3/8	10	22	15,3	7
FSPG0806	1/2	3/8	10	27	16,7	7
FSPG0808	1/2	1/2	12	27	17,2	9,5
FSPG1208	3/4	1/2	12	32	20,2	9,5
FSPG1210	3/4	5/8	16	32	20,2	12
FSPG1212	3/4	3/4	20	32	20,4	15
FSPG1616	1"	1"	25	38	21,2	20

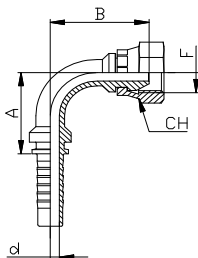
C90G
BSP SWEPT 90° FEMALE, 60° CONE

Artikelcode	Draad F	Slangmaat		Afmeting (mm)			
		Inch	mm	CH	A	B	d
C90G0203	1/8	3/16	5	15	23	26	3
C90G0204	1/8	1/4	6	15	22	28	4
C90G0403	1/4	3/16	5	19	23	27,5	3
C90G0404	1/4	1/4	6	19	21	30	4
C90G0405	1/4	5/16	8	19	28,5	34	5,5
C90G0406	1/4	3/8	10	19	28,5	34	7
C90G0604	3/8	1/4	6	22	26	32	4
C90G0605	3/8	5/16	8	22	32	38	5,5
C90G0606	3/8	3/8	10	22	34	38	7
C90G0608	3/8	1/2	12	22	42	39	7
C90G0805	1/2	5/16	8	27	33	41	5,5
C90G0806	1/2	3/8	10	27	35	42	7
C90G0808	1/2	1/2	12	27	40	44	9,5
C90G0810	1/2	5/8	16	27	43	47	12
C90G1008	5/8	1/2	12	28	40	45	9,5
C90G1010	5/8	5/8	16	28	51	50	12
C90G1208	3/4	1/2	12	32	39	50	9,5
C90G1210	3/4	5/8	16	32	52	54	12
C90G1212	3/4	3/4	20	32	56	59	15
C90G1612	1"	3/4	20	38	57	63	15
C90G1616	1"	1"	25	38	76	69	20
C90G2016	1"1/4	1"	25	50	72	79	20
C90G2020	1"1/4	1"1/4	32	50	87	89	26

PC90G

BSP SWEPT 90° FEMALE THRUST WIRE NUT, 60° CONE

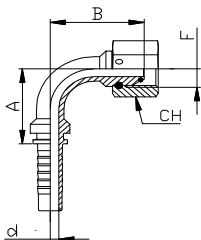

Artikelcode	Draad F	Slangmaat		Afmeting (mm)			
		Inch	mm	CH	A	B	d
PC90G1210	3/4	5/8	16	32	45	49	12
PC90G1212	3/4	3/4	20	32	56	56	15
PC90G1612	1"	3/4	20	38	56	59	15
PC90G1616	1"	1"	25	38	70	67	20
PC90G2016	1 1/4	1"	25	50	72	79	20
PC90G2020*	1 1/4	1 1/4	32	50	85	86	26
PC90G2420*	1 1/2	1 1/4	32	55	85	93	26
PC90G2424*	1 1/2	1 1/2	40	55	99	100	32
PC90G3224*	2"	1 1/2	40	70	99	125	32
PC90G3232*	2"	2"	50	70	125	132	44

* MET O-RING

SC90G

BSP SWEPT 90° FEMALE SLIP BACK NUT, 60° CONE

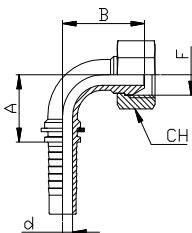

Artikelcode	Draad F	Slangmaat		Afmeting (mm)			
		Inch	mm	CH	A	B	d
SC90G0404	1/4	1/4	6	19	21	30	4
SC90G0604	3/8	1/4	6	22	26	32	4
SC90G0605	3/8	5/16	8	22	32	38	5,5
SC90G0606	3/8	3/8	10	22	34	38	7
SC90G0806	1/2	3/8	10	27	35	42	7
SC90G0808	1/2	1/2	12	27	40	44	9,5

C90COMPG

BSP FEMALE 90° COMPACT ELBOW, 60° CONE

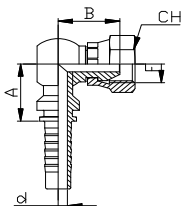

Artikelcode	Draad F	Slangmaat		Afmeting (mm)			
		Inch	mm	CH	A	B	d
C90COMPG0404	1/4	1/4	6	19	17,6	19	4
C90COMPG0605	3/8	5/16	8	22	20,4	22	5,5
C90COMPG0606	3/8	3/8	10	22	21,3	24	7
C90COMPG0808	1/2	1/2	12	27	24,1	25	9,5
C90COMPG1212	3/4	3/4	20	32	27,2	34	15
C90COMPG1616	1"	1"	25	38	33,5	39	20

C45G

BSP SWEPT 45° FEMALE, 60° CONE

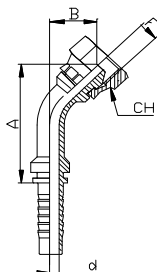

Artikelcode	Draad F	Slangmaat		Afmeting (mm)			
		Inch	mm	CH	A	B	d
C45G0203	1/8	3/16	5	15	38	16	3
C45G0204	1/8	1/4	6	15	42	20	4
C45G0403	1/4	3/16	5	19	40	20	3
C45G0404	1/4	1/4	6	19	40	16	4
C45G0405	1/4	5/16	8	19	40	20	5,5
C45G0406	1/4	3/8	10	19	42	20	7
C45G0604	3/8	1/4	6	22	40	18	4
C45G0605	3/8	5/16	8	22	51	19	5,5
C45G0606	3/8	3/8	10	22	56	19	7
C45G0608	3/8	1/2	12	22	62	23	7
C45G0805	1/2	5/16	8	27	48	25	5,5
C45G0806	1/2	3/8	10	27	50	19,5	7
C45G0808	1/2	1/2	12	27	65	25	9,5
C45G0810	1/2	5/8	16	27	55	31	12
C45G1008	5/8	1/2	12	28	61	31	9,5
C45G1010	5/8	5/8	16	28	63	31	12
C45G1208	3/4	1/2	12	32	68	29	9,5
C45G1210	3/4	5/8	16	32	68	29	12
C45G1212	3/4	3/4	20	32	64	30	15
C45G1612	1"	3/4	20	38	64	35	15
C45G1616	1"	1"	25	38	88	35	20
C45G2016	1"1/4	1"	25	50	91	43	20
C45G2020	1"1/4	1"1/4	32	50	105	50	26

PC45G

BSP SWEPT 45° FEMALE THRUST WIRE NUT, 60° CONE

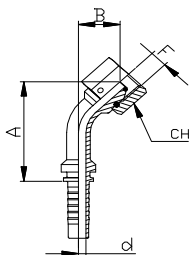

Artikelcode	Draad F	Slangmaat		Afmeting (mm)			
		Inch	mm	CH	A	B	d
PC45G1210	3/4	5/8	16	32	61	26	12
PC45G1212	3/4	3/4	20	32	71	29	15
PC45G1612	1"	3/4	20	38	74	32	15
PC45G1616	1"	1"	25	38	84	35	20
PC45G2016	1 1/4	1"	25	50	86	37	20
PC45G2020*	1 1/4	1 1/4	32	50	103	50	26
PC45G2420*	1 1/2	1 1/4	32	55	105	55	26
PC45G2424*	1 1/2	1 1/2	40	55	116	55	32
PC45G3224*	2"	1 1/2	40	70	117	66	32
PC45G3232*	2"	2"	50	70	143	70	44

* MET O-RING

SC45G

BSP SWEPT 45° FEMALE SLIP BACK NUT, 60° CONE

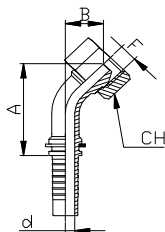

Artikelcode	Draad F	Slangmaat		Afmeting (mm)			
		Inch	mm	CH	A	B	d
SC45G0404	1/4	1/4	6	19	40	16	4
SC45G0604	3/8	1/4	6	22	39	18	4
SC45G0605	3/8	5/16	8	22	51	19	5,5
SC45G0606	3/8	3/8	10	22	56	19	7
SC45G0806	1/2	3/8	10	27	50	19,5	7
SC45G0808	1/2	1/2	12	27	65	25	9,5

OG

BSP BANJO

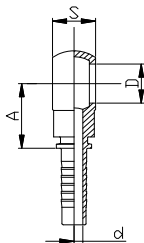

Artikelcode	Banjobout	Slangmaat		Afmeting (mm)		
		Inch	mm	A	S	d
OG0203	1/8	3/16	5	20,3	10	3
OG0204	1/8	1/4	6	20,6	10	4
OG0403	1/4	3/16	5	26,1	13,8	3
OG0404	1/4	1/4	6	23,1	13,8	4
OG0405	1/4	5/16	8	25,1	13,8	5,5
OG0406	1/4	3/8	10	31,9	13,8	7
OG0604	3/8	1/4	6	27,5	17	4
OG0605	3/8	5/16	8	27,5	17	5,5
OG0606	3/8	3/8	10	27,6	17	7
OG0608	3/8	1/2	12	32,1	17	9,5
OG0805	1/2	5/16	8	27,2	22	5,5
OG0806	1/2	3/8	10	27,8	22	7
OG0808	1/2	1/2	12	34,7	22	9,5
OG0810	1/2	5/8	16	34,7	23,3	12
OG1008	5/8	1/2	12	39,8	23	9,5
OG1010	5/8	5/8	16	41,3	23	12
OG1208	3/4	1/2	12	34,6	30	9,5
OG1210	3/4	5/8	16	35,3	30	12
OG1212	3/4	3/4	20	35,7	30	15
OG1612	1"	3/4	20	51,5	38	15
OG1616	1"	1"	25	43,9	38	20
OG2016	1 1/4	1"	25			
OG2020	1 1/4	1 1/4	32	53	42	26
OG2420	1 1/2	1 1/4	32			
OG2424	1 1/2	1 1/2	40			
OG3224	2"	1 1/2	40			
OG3232	2"	2"	50			

MG

BSPP MALE, 60° SEAT

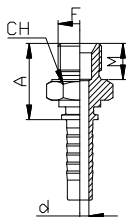

Artikelcode	Draad F	Slangmaat		Afmeting (mm)			
		Inch	mm	CH	A	M	d
MG0203	1/8	3/16	5	15	21,6	9,6	3
MG0204	1/8	1/4	6	15	21,9	9,6	4
MG0403	1/4	3/16	5	19	24,5	11,2	3
MG0404	1/4	1/4	6	19	24,8	11,2	4
MG0405	1/4	5/16	8	19	25	11,2	5,5
MG0406	1/4	3/8	10	19	25,1	11,2	7
MG0604	3/8	1/4	6	22	28,3	13,6	4
MG0605	3/8	5/16	8	22	28,5	13,6	5,5
MG0606	3/8	3/8	10	22	28,6	13,6	7
MG0608	3/8	1/2	12	22	29,1	13,6	7
MG0804	1/2	1/4	6	22	30,8	14,8	4
MG0805	1/2	5/16	8	27	30,8	14,8	5,5
MG0806	1/2	3/8	10	27	30,9	14,8	7
MG0808	1/2	1/2	12	27	31,4	14,8	9,5
MG0810	1/2	5/8	16	27	31,4	14,8	12
MG1008	5/8	1/2	12	28	33	16	9,5
MG1010	5/8	5/8	16	28	35	16	12
MG1208	3/4	1/2	12	32	34,7	17	9,5
MG1210	3/4	5/8	16	32	34,7	17	12
MG1212	3/4	3/4	20	32	35,1	17	15
MG1610	1"	5/8	16	41	38,6	20,3	12
MG1612	1"	3/4	20	41	39,8	20,3	15
MG1616	1"	1"	25	41	41,1	20,3	20
MG2016	1 1/4	1"	25	50	46,3	22	20
MG2020	1 1/4	1 1/4	32	50	46,9	22	26
MG2420	1 1/2	1 1/4	32	55	47,2	22	26
MG2424	1 1/2	1 1/2	40	55	48,1	22	32
MG3224	2"	1 1/2	40	70	51,3	24	32
MG3232	2"	2"	50	70	51,3	24	44

MC

BSPT MALE, 60° SEAT

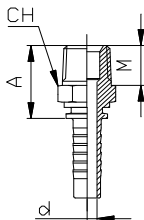

Artikelcode	Draad F	Slangmaat		Afmeting (mm)			
		Inch	mm	CH	A	M	d
MC0203	1/8	3/16	5	12	21,9	10	3
MC0204	1/8	1/4	6	12	22,2	10	4
MC0403	1/4	3/16	5	15	27	14	3
MC0404	1/4	1/4	6	15	27	14	4
MC0405	1/4	5/16	8	15	27	14	5,5
MC0406	1/4	3/8	10	15	27,1	14	7
MC0604	3/8	1/4	6	19	28,5	14,5	4
MC0605	3/8	5/16	8	19	28,7	14,5	5,5
MC0606	3/8	3/8	10	19	28,8	14,5	7
MC0608	3/8	1/2	12	19	29,3	14,5	7
MC0805	1/2	5/16	8				
MC0806	1/2	3/8	10	22	34,3	19	7
MC0808	1/2	1/2	12	22	34,8	19	9,5
MC0810	1/2	5/8	16				
MC1008	5/8	1/2	12				
MC1010	5/8	5/8	16				
MC1208	3/4	1/2	12	27	35,8	19	9,5
MC1210	3/4	5/8	16	27	35,8	19	12
MC1212	3/4	3/4	20	27	36,5	19	15
MC1610	1"	5/8	16				
MC1612	1"	3/4	20	36	42,5	24	15
MC1616	1"	1"	25	36	43,8	24	20
MC2016	1"1/4	1"	25	46	47,8	24,5	20
MC2020	1"1/4	1"1/4	32	46	48,4	24,5	26
MC2420	1"1/2	1"1/4	32	50	49,2	25	26
MC2424	1"1/2	1"1/2	40	50	50,1	25	32
MC3224	2"	1"1/2	40				
MC3232	2"	2"	50	65	52,3	26	44

MNPT

NPTF MALE

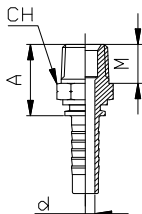

Artikelcode	Draad F	Slangmaat		Afmeting (mm)			
		Inch	mm	CH	A	M	d
MNPT0203	1/8 - 27	3/16	5	12	21,6	9,7	3
MNPT0204	1/8 - 27	1/4	6	12	21,9	9,7	4
MNPT0403	1/4 - 18	3/16	5	15	26,9	14,2	3
MNPT0404	1/4 - 18	1/4	6	15	27,2	14,2	4
MNPT0405	1/4 - 18	5/16	8	15	27,2	14,2	5,5
MNPT0406	1/4 - 18	3/8	10	15	27,3	14,2	7
MNPT0604	3/8 - 18	1/4	6	19	28,2	14,2	4
MNPT0605	3/8 - 18	5/16	8	19	28,4	14,2	5,5
MNPT0606	3/8 - 18	3/8	10	19	28,5	14,2	7
MNPT0608	3/8 - 18	1/2	12	19	29	14,2	9,5
MNPT0805	1/2 - 14	5/16	8				
MNPT0806	1/2 - 14	3/8	10	22	34,3	19	7
MNPT0808	1/2 - 14	1/2	12	22	34,8	19	9,5
MNPT0810	1/2 - 14	5/8	16				
MNPT1208	3/4 - 14	1/2	12	27	35,8	19	9,5
MNPT1210	3/4 - 14	5/8	16	27	35,8	19	12
MNPT1212	3/4 - 14	3/4	20	27	36,5	19	15
MNPT1610	1" - 11,5	5/8	16				
MNPT1612	1" - 11,5	3/4	20	36	42,4	23,9	15
MNPT1616	1" - 11,5	1"	25	36	43,7	23,9	20
MNPT2016	1 1/4 - 11,5	1"	25	46	47,9	24,6	20
MNPT2020	1 1/4 - 11,5	1 1/4	32	46	48,5	24,6	26
MNPT2420	1 1/2 - 11,5	1 1/4	32	50	49,6	25,4	26
MNPT2424	1 1/2 - 11,5	1 1/2	40	50	50,5	25,4	32
MNPT3224	2" - 11,5	1 1/2	40				
MNPT3232	2" - 11,5	2"	50	65	52,5	26,2	44

FJ

JIC FEMALE, 37° SEAT

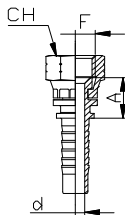

Artikelcode	Draad F	Slangmaat		Afmeting (mm)		
		Inch	mm	CH	A	d
FJ0603	7/16-20	3/16	5	15	15,1	3
FJ0604	7/16-20	1/4	6	15	15,4	4
FJ0804	1/2-20	1/4	6	17	14,9	4
FJ0805	1/2-20	5/16	8	17	14,9	5,5
FJ1004	9/16-18	1/4	6	19	16,3	4
FJ1005	9/16-18	5/16	8	19	16,3	5,5
FJ1006	9/16-18	3/8	10	19	16,4	7
FJ1106	5/8-18	3/8	10	22	17,3	7
FJ1205	3/4-16	5/16	8	24	16,8	5,5
FJ1206	3/4-16	3/8	10	24	16,9	7
FJ1208	3/4-16	1/2	12	24	17,4	9,5
FJ1606	7/8-14	3/8	10	27	19	7
FJ1608	7/8-14	1/2	12	27	19,5	9,5
FJ1610	7/8-14	5/8	16	27	19,5	12
FJ2008	1*1/16-12	1/2	12	32	23,3	9,5
FJ2010	1*1/16-12	5/8	16	32	23,3	12
FJ2012	1*1/16-12	3/4	20	32	23,5	15
FJ2212	1*3/16-12	3/4	20	36	22	15
FJ2512	1*5/16-12	3/4	20	41	24,7	15
FJ2516	1*5/16-12	1"	25	41	26	20
FJ3416	1*5/8-12	1"	25	50	28,7	20
FJ3420	1*5/8-12	1*1/4	32	50	29,3	26

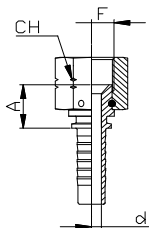
PFJ
JIC FEMALE THRUST WIRE NUT, 37° SEAT

Artikelcode	Draad F	Slangmaat		Afmeting (mm)		
		Inch	mm	CH	A	d
PFJ2010	1*1/16-12	5/8	16	32	21	12
PFJ2012	1*1/16-12	3/4	20	32	21	15
PFJ2512	1*5/16-12	3/4	20	41	24	15
PFJ2516	1*5/16-12	1*	25	41	25	20
PFJ3416	1*5/8-12	1*	25	50	27	20
PFJ3420	1*5/8-12	1*1/4	32	50	28	26
PFJ4020	1*7/8-12	1*1/4	32	55	31	26
PFJ4024	1*7/8-12	1*1/2	40	55	31	32
PFJ5032	2*1/2-12	2*	50	70	31	44

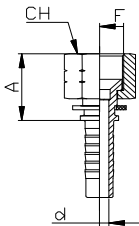
SFJ
JIC FEMALE SLIP BACK NUT, 37° SEAT

Artikelcode	Draad F	Slangmaat		Afmeting (mm)		
		Inch	mm	CH	A	d
SFJ1004	9/16-18	1/4	6	19	16,3	4
SFJ1206	3/4-16	3/8	10	24	16,9	7
SFJ1606	7/8-14	3/8	10	27	19	7
SFJ1608	7/8-14	1/2	12	27	19,5	9,5

FJDE

JIC FEMALE DOUBLE HEXAGON, 37° SEAT

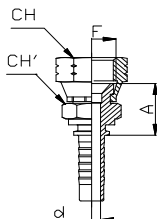

Artikelcode	Draad F	Slangmaat		Afmeting (mm)			
		Inch	mm	CH	CH'	A	d
FJDE0604	7/16-20	1/4	6	15	14	21,5	4
FJDE0804	1/2-20	1/4	6	17	17	21,5	4
FJDE1004	9/16-18	1/4	6	19	17	21,5	4
FJDE1005	9/16-18	5/16	8	19	17	21,5	5,5
FJDE1006	9/16-18	3/8	10	19	19	20	7
FJDE1206	3/4-16	3/8	10	24	19	20	7
FJDE1208	3/4-16	1/2	12	24	22	27	9,5
FJDE1608	7/8-14	1/2	12	27	22	27	9,5
FJDE2012	1*1/16-12	3/4	20	32	27	34	15
FJDE2516	1*5/16-12	1*	25	41	32	35	20

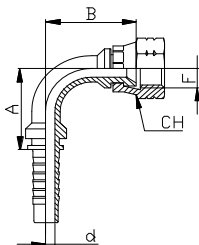
C90J
JIC SWPT 90° FEMALE, 37° SEAT

Artikelcode	Draad F	Slangmaat		Afmeting (mm)			
		Inch	mm	CH	A	B	d
C90J0603	7/16-20	3/16	5	15	22	22	3
C90J0604	7/16-20	1/4	6	15	23	24	4
C90J0804	1/2-20	1/4	6	17	23	25	4
C90J0805	1/2-20	5/16	8	17	30	29	5,5
C90J1004	9/16-18	1/4	6	19	23	27	4
C90J1005	9/16-18	5/16	8	19	32	30	5,5
C90J1006	9/16-18	3/8	10	19	32	33	7
C90J1106	5/8-18	3/8	10	22	33	37	7
C90J1205	3/4-16	5/16	8	24	32	37	5,5
C90J1206	3/4-16	3/8	10	24	32	35	7
C90J1208	3/4-16	1/2	12	24	40	40	9,5
C90J1606	7/8-14	3/8	10	27	32	35	7
C90J1608	7/8-14	1/2	12	27	42	42	9,5
C90J1610	7/8-14	5/8	16	27	49	49	12
C90J2008	1*1/16-12	1/2	12	32	40	48	9,5
C90J2010	1*1/16-12	5/8	16	32	52	53	12
C90J2012	1*1/16-12	3/4	20	32	57	55	15
C90J2212	1*3/16-12	3/4	20	36	58	64	15
C90J2512	1*5/16-12	3/4	20	41	60	59	15
C90J2516	1*5/16-12	1"	25	41	75	68	20
C90J3416	1*5/8-12	1"	25	50	75	73	20
C90J3420	1*5/8-12	1*1/4	32	50	89	83	26

PC90J

JIC SWEPT 90° FEMALE THRUST WIRE NUT, 37° SEAT

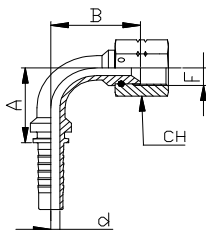

Artikelcode	Draad F	Slangmaat		Afmeting (mm)			
		Inch	mm	CH	A	B	d
PC90J2010	1"1/16-12	5/8	16	32	45	47	12
PC90J2012	1"1/16-12	3/4	20	32	56	53	15
PC90J2512	1"5/16-12	3/4	20	41	56	60	15
PC90J2516	1"5/16-12	1"	25	41	70	68	20
PC90J3416	1"5/8-12	1"	25	50	75	73	20
PC90J3420	1"5/8-12	1"1/4	32	50	85	88	26
PC90J4020	1"7/8-12	1"1/4	32	55	85	101	26
PC90J4024	1"7/8-12	1"1/2	40	55	99	101	32
PC90J5032	2"1/2-12	2"	50	70	125	132	44

SC90J

JIC SWEPT 90° FEMALE SLIP BACK NUT, 37° SEAT

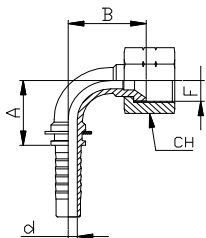

Artikelcode	Draad F	Slangmaat		Afmeting (mm)			
		Inch	mm	CH	A	B	d
SC90J1004	9/16-18	1/4	6	19	23	27	4
SC90J1206	3/4-16	3/8	10	24	32	35	7
SC90J1606	7/8-14	3/8	10	27	32	35	7
SC90J1608	7/8-14	1/2	12	27	41,6	42	9,5

C90COMPJ

JIC FEMALE 90° COMPACT ELBOW, 37° SEAT

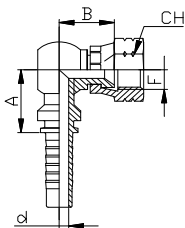

Artikelcode	Draad F	Slangmaat		Afmeting (mm)			
		Inch	mm	CH	A	B	d
C90COMPJ0604	7/16-20	1/4	6	15	14	20	4
C90COMPJ0804	1/2-20	1/4	6	17	14	21	4
C90COMPJ1004	9/16-18	1/4	6	19	15	24	4
C90COMPJ1005	9/16-18	5/16	8	19	15	24	5,5
C90COMPJ1006	9/16-18	3/8	10	19	18	24	7
C90COMPJ1206	3/4-16	3/8	10	24	20	23	7
C90COMPJ1208	3/4-16	1/2	12	24	21	23	9,5
C90COMPJ1608	7/8-14	1/2	12	27	21	23	9,5
C90COMPJ1610	7/8-14	5/8	16	27	23	27	12
C90COMPJ2010	1*1/16-12	5/8	16	32	23	29	12
C90COMPJ2012	1*1/16-12	3/4	20	32	27	31	15
C90COMPJ2516	1*5/16-12	1"	25	41	35	37	20

C45J

JIC SWEPT 45° FEMALE, 37° SEAT

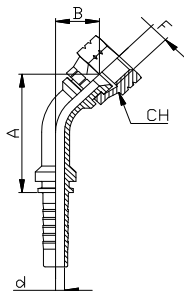

Artikelcode	Draad F	Slangmaat		Afmeting (mm)			
		Inch	mm	CH	A	B	d
C45J0603	7/16-20	3/16	5	15	38	16	3
C45J0604	7/16-20	1/4	6	15	36	12	4
C45J0804	1/2-20	1/4	6	17	36	13	4
C45J0805	1/2-20	5/16	8	17	36	16	5,5
C45J1004	9/16-18	1/4	6	19	37	13	4
C45J1005	9/16-18	5/16	8	19	48	15	5,5
C45J1006	9/16-18	3/8	10	19	51	15	7
C45J1106	5/8-18	3/8	10	22	51	18	7
C45J1205	3/4-16	5/16	8	24	54	20	5,5
C45J1206	3/4-16	3/8	10	24	41	18	7
C45J1208	3/4-16	1/2	12	24	63	20	9,5
C45J1606	7/8-14	3/8	10	27	54	20	7
C45J1608	7/8-14	1/2	12	27	69	21	9,5
C45J1610	7/8-14	5/8	16	27	78	25	12
C45J2008	1*1/16-12	1/2	12	32	66	29	9,5
C45J2010	1*1/16-12	5/8	16	32	61	24	12
C45J2012	1*1/16-12	3/4	20	32	62	27	15
C45J2212	1*3/16-12	3/4	20	36	65	35	15
C45J2512	1*5/16-12	3/4	20	41	67	29	15
C45J2516	1*5/16-12	1"	25	41	87	32	20
C45J3416	1*5/8-12	1"	25	50	91	35	20
C45J3420	1*5/8-12	1*1/4	32	50	101	43	26

PC45J

JIC SWEPT 45° FEMALE THRUST WIRE NUT, 37° SEAT

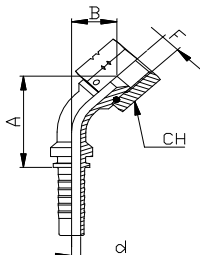

Artikelcode	Draad F	Slangmaat		Afmeting (mm)			
		Inch	mm	CH	A	B	d
PC45J2010	1"1/16-12	5/8	16	32	60	25	12
PC45J2012	1"1/16-12	3/4	20	32	70	28	15
PC45J2512	1"5/16-12	3/4	20	41	74	32	15
PC45J2516	1"5/16-12	1"	25	41	85	36	20
PC45J3416	1"5/8-12	1"	25	50	91	35	20
PC45J3420	1"5/8-12	1"1/4	32	50	105	52	26
PC45J4020	1"7/8-12	1"1/4	32	55	106	55	26
PC45J4024	1"7/8-12	1"1/2	40	55	117	56	32
PC45J5032	2"1/2-12	2"	50	70	142	68	44

SC45J

JIC SWEPT 45° FEMALE SLIP BACK NUT, 37° SEAT

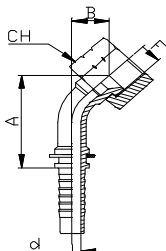

Artikelcode	Draad F	Slangmaat		Afmeting (mm)			
		Inch	mm	CH	A	B	d
SC45J1004	9/16-18	1/4	6	19	37,4	13	4
SC45J1206	3/4-16	3/8	10	24	40,7	18	7
SC45J1606	7/8-14	3/8	10	27	54,4	20	7
SC45J1608	7/8-14	1/2	12	27	69,4	21	9,5

MJ

JIC MALE, 37° CONE

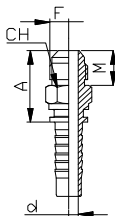

Artikelcode	Draad F	Slangmaat		Afmeting (mm)			
		Inch	mm	CH	A	M	d
MJ0603	7/16-20	3/16	5	12	26,5	14,1	3
MJ0604	7/16-20	1/4	6	12	26,8	14,1	4
MJ0804	1/2-20	1/4	6	15	28,1	14,1	4
MJ0805	1/2-20	5/16	8	15	28,3	14,1	5,5
MJ1004	9/16-18	1/4	6	15	28,3	14,1	4
MJ1005	9/16-18	5/16	8	15	28,5	14,1	5,5
MJ1006	9/16-18	3/8	10	15	28,6	14,1	7
MJ1106	5/8-18	3/8	10	17	29	16	7
MJ1204	3/4-16	1/4	10	19	31,2	17,2	4
MJ1205	3/4-16	5/16	8	19	31,4	17,2	5,5
MJ1206	3/4-16	3/8	10	19	31,5	17,2	7
MJ1208	3/4-16	1/2	12	19	32	17,2	9,5
MJ1606	7/8-14	3/8	10	24	34,8	19,5	7
MJ1608	7/8-14	1/2	12	24	35,3	19,5	9,5
MJ1610	7/8-14	5/8	16	24	35,3	19,5	12
MJ2008	1*1/16-12	1/2	12	27	39,4	21,9	9,5
MJ2010	1*1/16-12	5/8	16	27	39,4	21,9	12
MJ2012	1*1/16-12	3/4	20	27	40,1	21,9	15
MJ2016	1*1/16-12	1"	25	32	41,1	21,9	20
MJ2212	1*3/16-12	3/4	20	32	41,5	22,5	15
MJ2512	1*5/16-12	3/4	20	34	42	23	15
MJ2516	1*5/16-12	1"	25	34	42,8	23	20
MJ3416	1*5/8-12	1"	25	42	46	24,3	20
MJ3420	1*5/8-12	1*1/4	32	42	46,5	24,3	26
MJ4020	1*7/8-12	1*1/4	32	50	51,8	27,5	26
MJ4024	1*7/8-12	1*1/2	40	50	52	27,5	32
MJ5032	2*1/2-12	2"	50	65	62	34	45

FEL

METRIC O-RING FEMALE, 24° CONE, DIN 3865 LIGHT

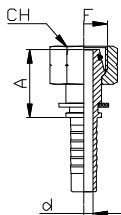

DKOL

Artikelcode	Draad F	Pijpmaat mm	Slangmaat		Afmeting (mm)		
			Inch	mm	CH	A	d
FEL0603	M12x1,5	6	3/16	5	14	26	3
FEL0604*	M12x1,5	6	1/4	6	14	26,3	4
FEL0804	M14x1,5	8	1/4	6	17	26,3	4
FEL1004	M16x1,5	10	1/4	6	19	27,5	4
FEL1005	M16x1,5	10	5/16	8	19	27,5	5,5
FEL1006*	M16x1,5	10	3/8	10	19	23,8	7
FEL1204	M18x1,5	12	1/4	6	22	27,5	4
FEL1205	M18x1,5	12	5/16	8	22	27,5	5,5
FEL1206	M18x1,5	12	3/8	10	22	27,6	7
FEL1506	M22x1,5	15	3/8	10	27	27,3	7
FEL1508	M22x1,5	15	1/2	12	27	27,8	9,5
FEL1808	M26x1,5	18	1/2	16	32	28	9,5
FEL1810	M26x1,5	18	5/8	16	32	28,8	12
FEL2212	M30x2	22	3/4	20	36	31	15
FEL2816	M36x2	28	1"	25	41	33,3	20
FEL3520	M45x2	35	1 1/4	32	50	37,7	26
FEL4224	M52x2	42	1 1/2	40	60	40,4	32

* CRIMPED NUT

C90EL

METRIC SWEPT 90° O-RING FEMALE, 24° CONE, DIN 3865 LIGHT

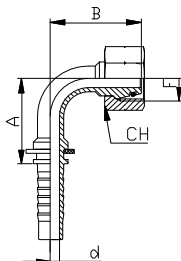

DKOL90

Artikelcode	Draad F	Pijpmaat mm	Slangmaat		Afmeting (mm)			
			Inch	mm	CH	A	B	d
C90EL0603	M12x1,5	6	3/16	5	14	21	28	3
C90EL0604*	M12x1,5	6	1/4	6	14	24	32	4
C90EL0804	M14x1,5	8	1/4	6	17	26	28	4
C90EL1004	M16x1,5	10	1/4	6	19	28	30	4
C90EL1005	M16x1,5	10	5/16	8	19	31	33	5,5
C90EL1006*	M16x1,5	10	3/8	10	19	31	43	7
C90EL1204	M18x1,5	12	1/4	6	22	24	31	4
C90EL1205	M18x1,5	12	5/16	8	22	30	34	5,5
C90EL1206	M18x1,5	12	3/8	10	22	35	35	7
C90EL1506	M22x1,5	15	3/8	10	27	37	38	7
C90EL1508	M22x1,5	15	1/2	12	27	40	41	9,5
C90EL1808	M26x1,5	18	1/2	12	32	40	43	9,5
C90EL1810	M26x1,5	18	5/8	16	32	48	49	12
C90EL2212	M30x2	22	3/4	20	36	55	54	15
C90EL2816	M36x2	28	1"	25	41	73	68	20
C90EL3520	M45x2	35	1"1/4	32	50	90	86	26
C90EL4224	M52x2	42	1"1/2	40	60	102	96	32

* CRIMPED NUT

C45EL

METRIC SWEPT 45° O-RING FEMALE, 24° CONE, DIN 3865 LIGHT

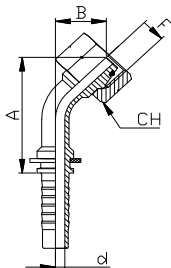

DKOL45

Artikelcode	Draad F	Pijpmaat mm	Slangmaat		Afmeting (mm)			
			Inch	mm	CH	A	B	d
C45EL0603	M12x1,5	6	3/16	5	14	36	15	3
C45EL0604*	M12x1,5	6	1/4	6	14	38	16	4
C45EL0804	M14x1,5	8	1/4	6	17	38	16	4
C45EL1004	M16x1,5	10	1/4	6	19	38	17	4
C45EL1005	M16x1,5	10	5/16	8	19	44	17	5,5
C45EL1006*	M16x1,5	10	3/8	10	19	60	21	7
C45EL1204	M18x1,5	12	1/4	6	22	40	18	4
C45EL1205	M18x1,5	12	5/16	8	22	46	19	5,5
C45EL1206	M18x1,5	12	3/8	10	22	47	18	7
C45EL1506	M22x1,5	15	3/8	10	27	49	20	7
C45EL1508	M22x1,5	15	1/2	12	27	56	20	9,5
C45EL1808	M26x1,5	18	1/2	12	32	57	24	9,5
C45EL1810	M26x1,5	18	5/8	16	32	57	21	12
C45EL2212	M30x2	22	3/4	20	36	69	26	15
C45EL2816	M36x2	28	1"	25	41	81	32	20
C45EL3520	M45x2	35	1 1/4	32	50	99	40	26
C45EL4224	M52x2	42	1 1/2	40	60	115	43	32

* CRIMPED NUT

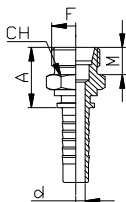
MEL
METRIC MALE, 24° SEAT, DIN 3853 LIGHT

CEL

Artikelcode	Draad F	Pijpmaat mm	Slangmaat		Afmeting (mm)			
			Inch	mm	CH	A	M	d
MEL0603	M12x1,5	6	3/16	5	12	20,7	10	3
MEL0604	M12x1,5	6	1/4	6	12	21	10	4
MEL0804	M14x1,5	8	1/4	6	14	22	10	4
MEL1004	M16x1,5	10	1/4	6	17	23	11	4
MEL1005	M16x1,5	10	5/16	8	17	23,2	11	5,5
MEL1006	M16x1,5	10	3/8	10	17	23,3	11	7
MEL1204	M18x1,5	12	1/4	6	19	24	11	4
MEL1205	M18x1,5	12	5/16	8	19	24,2	11	5,5
MEL1206	M18x1,5	12	3/8	10	19	24,3	11	7
MEL1506	M22x1,5	15	3/8	10	24	25,3	12	7
MEL1508	M22x1,5	15	1/2	12	24	25,8	12	9,5
MEL1808	M26x1,5	18	1/2	12	27	26,8	12	9,5
MEL1810	M26x1,5	18	5/8	16	27	26,8	12	12
MEL1812	M26x1,5	18	3/4	20	27	27,5	12	15
MEL2212	M30x2	22	3/4	20	32	29,5	14	15
MEL2816	M36x2	28	1"	25	41	31,8	14	20
MEL3520	M45x2	35	1 1/4	32	46	40	16	26
MEL4224	M52x2	42	1 1/2	40	55	42,6	16	32

FES

METRIC O-RING FEMALE, 24° CONE, DIN 3865 HEAVY

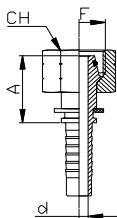

DKOS

Artikelcode	Draad F	Pijpmaat mm	Slangmaat		Afmeting (mm)		
			Inch	mm	CH	A	d
FES0603	M14x1,5	6	3/16	5	17	26	3
FES0604*	M14x1,5	6	1/4	6	17	26,3	4
FES0804	M16x1,5	8	1/4	6	19	26,3	4
FES1004	M18x1,5	10	1/4	6	22	27,5	4
FES1005	M18x1,5	10	5/16	8	22	27,5	5,5
FES1006*	M18x1,5	10	3/8	10	22	23,8	7
FES1204	M20x1,5	12	1/4	6	24	27,5	4
FES1205	M20x1,5	12	5/16	8	24	27,5	5,5
FES1206	M20x1,5	12	3/8	10	24	27,6	7
FES1406	M22x1,5	14	3/8	10	27	30,8	7
FES1608	M24x1,5	16	1/2	12	30	31,3	9,5
FES2010	M30x2	20	5/8	16	36	35,8	12
FES2012	M30x2	20	3/4	20	36	36	15
FES2512	M36x2	25	3/4	20	46	39	15
FES2516	M36x2	25	1"	25	46	40,3	20
FES3016	M42x2	30	1"	25	50	42,4	20
FES3820	M52x2	38	1 1/4	32	60	46	26

* CRIMPED NUT

C90ES

METRIC SWEPT 90° O-RING FEMALE, 24° CONE, DIN 3865 HEAVY

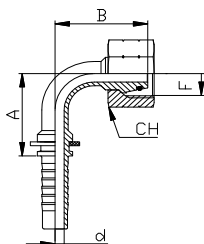

DKOS90

Artikelcode	Draad F	Pijpmaat mm	Slangmaat		Afmeting (mm)			
			Inch	mm	CH	A	B	d
C90ES0603	M14x1,5	6	3/16	5	17	21	28	3
C90ES0604*	M14x1,5	6	1/4	6	17	24	32	4
C90ES0804	M16x1,5	8	1/4	6	19	26	28	4
C90ES1004	M18x1,5	10	1/4	6	22	28	30	4
C90ES1005	M18x1,5	10	5/16	8	22	31	33	5,5
C90ES1006*	M18x1,5	10	3/8	10	22	31	43	7
C90ES1204	M20x1,5	12	1/4	6	24	24	31	4
C90ES1205	M20x1,5	12	5/16	8	24	30	34	5,5
C90ES1206	M20x1,5	12	3/8	10	24	35	35	7
C90ES1406	M22x1,5	14	3/8	10	27	33	37	7
C90ES1608	M24x1,5	16	1/2	12	30	39	42	9,5
C90ES2010	M30x2	20	5/8	16	36	54	53	12
C90ES2012	M30x2	20	3/4	20	36	57	59	15
C90ES2512	M36x2	25	3/4	20	46	61	99	15
C90ES2516	M36x2	25	1"	25	46	75	71	20
C90ES3016	M42x2	30	1"	25	50	79	71	20
C90ES3820	M52x2	38	1 1/4	32	60	90	86	26

* CRIMPED NUT

C45ES

METRIC SWEPT 45° O-RING FEMALE, 24° CONE, DIN 3865 HEAVY

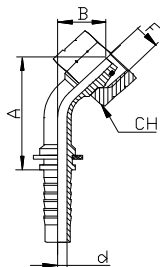

DKOL45

Artikelcode	Draad F	Pijpmaat		Slangmaat		Afmeting (mm)			
		mm	Inch	mm	mm	CH	A	B	d
C45ES0603	M14x1,5	6	3/16	5	17	36	15	3	
C45ES0604*	M14x1,5	6	1/4	6	17	38	16	4	
C45ES0804	M16x1,5	8	1/4	6	19	38	16	4	
C45ES1004	M18x1,5	10	1/4	6	22	38	17	4	
C45ES1005	M18x1,5	10	5/16	8	22	44	17	5,5	
C45ES1006*	M18x1,5	10	3/8	10	22	60	21	7	
C45ES1204	M20x1,5	12	1/4	6	24	40	18	4	
C45ES1205	M20x1,5	12	5/16	8	24	46	19	5,5	
C45ES1206	M20x1,5	12	3/8	10	24	47	18	7	
C45ES1406	M22x1,5	14	3/8	10	27	49	20	7	
C45ES1608	M24x1,5	16	1/2	12	30	57	21	9,5	
C45ES2010	M30x2	20	5/8	16	36	70	27	12	
C45ES2012	M30x2	20	3/4	20	36	70	29	15	
C45ES2512	M36x2	25	3/4	20	46	70	29	15	
C45ES2516	M36x2	25	1"	25	46	82	33	20	
C45ES3016	M42x2	30	1"	25	50	82	33	20	
C45ES3820	M52x2	38	1 1/4	32	60	99	40	26	

* CRIMPED NUT

MES

METRIC MALE, 24° SEAT, DIN 3853 HEAVY

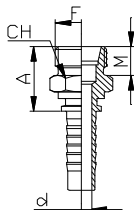

CES

Artikelcode	Draad F	Pijpmaat mm	Slangmaat		Afmeting (mm)			
			Inch	mm	CH	A	M	d
MES0603	M14x1,5	6	3/16	5				
MES0604	M14x1,5	6	1/4	6				
MES0804	M16x1,5	8	1/4	6	17	27	12	4
MES1004	M18x1,5	10	1/4	6	19	27	12	4
MES1005	M18x1,5	10	5/16	8	19	27,2	12	5,5
MES1006	M18x1,5	10	3/8	10	19	27,3	12	7
MES1204	M20x1,5	12	1/4	6	22	29	12	4
MES1205	M20x1,5	12	5/16	8	22	29,2	12	5,5
MES1206	M20x1,5	12	3/8	10	22	29,3	12	7
MES1406	M22x1,5	14	3/8	10	24	31,3	14	7
MES1408	M22x1,5	14	1/2	12	24	31,8	14	9,5
MES1608	M24x1,5	16	1/2	12	27	31,8	14	9,5
MES2010	M30x2	20	5/8	16	32	35,8	16	12
MES2012	M30x2	20	3/4	20	32	36,5	16	15
MES2512	M36x2	25	3/4	20	38	39,5	18	15
MES2516	M36x2	25	1"	25	38	40,8	18	20
MES3016	M42x2	30	1"	25	46	43,8	20	20
MES3820	M52x2	38	1 1/4	32	55	47,4	22	26

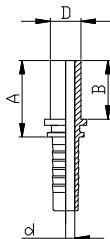
COD
METRIC STANDPIPE, DIN 2353

Artikelcode	Pijpmaat D (mm)	Slangmaat		Afmeting (mm)		
		Inch	mm	A	B	d
COD0603	6	3/16	5	30,7	24	3
COD0604	6	1/4	6	31	24	4
COD0803	8	3/16	5	30,7	24	3
COD0804	8	1/4	6	31	24	4
COD0805	8	5/16	8	31,2	24	5,5
COD1004	10	1/4	6	31,2	24	4
COD1005	10	5/16	8	31,2	24	5,5
COD1006	10	3/8	10	31,3	24	7
COD1204	12	1/4	6	32	27,3	4
COD1205	12	5/16	8	32,2	25	5,5
COD1206	12	3/8	10	32,3	25	7
COD1208	12	1/2	12	32,8	25	9,5
COD1406	14	3/8	10	36,3	29	7
COD1408	14	1/2	12	36,8	29	9,5
COD1506	15	3/8	10	36,3	29	7
COD1508	15	1/2	12	36,8	29	9,5
COD1608	16	1/2	12	36,8	29	9,5
COD1808	18	1/2	12	36,8	29	9,5
COD1810	18	5/8	16	36,8	29	12
COD1812	18	3/4	20	37,5	29	15
COD2008	20	1/2	12	43,8	38,5	9,5
COD2010	20	5/8	16	43,8	36	12
COD2012	20	3/4	20	44,5	36	15
COD2210	22	5/8	16	36,8	29	12
COD2212	22	3/4	20	37,5	29	15
COD2512	25	3/4	20	44,5	36	15
COD2516	25	1"	25	45,8	36	20
COD2816	28	1"	25	45,8	36	20
COD3016	30	1"	25	45,8	36	20
COD3520	35	1 1/4	32	47	35	26
COD3820	38	1 1/4	32	59,1	48	26
COD3824	38	1 1/2	40	60	48	32
COD4224	42		40	47,4	36	32

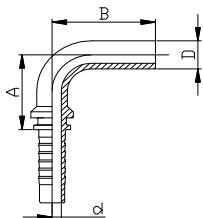
COD90
METRIC SWEPT 90° STANDPIPE, DIN 2353

Artikelcode	Pijpmaat D (mm)	Slangmaat		Afmeting (mm)		
		Inch	mm	A	B	d
COD900603	6	3/16	5	27,5	37,6	3
COD900604	6	1/4	6	27,5	37,6	4
COD900803	8	3/16	5	27,5	37,6	3
COD900804	8	1/4	6	27,5	37,6	4
COD900805	8	5/16	8	27,5	37,6	5,5
COD901004	10	1/4	6	32	35,5	4
COD901005	10	5/16	8	32	43,6	5,5
COD901006	10	3/8	10	32	40,8	7
COD901204	12	1/4	6	33	42,5	4
COD901205	12	5/16	8	33	44	5,5
COD901206	12	3/8	10	33	48	7
COD901208	12	1/2	12	33	45	9,5
COD901406	14	3/8	10	35	48	7
COD901408	14	1/2	12	35	48	9,5
COD901506	15	3/8	10	38	53	7
COD901508	15	1/2	12	38	53	9,5
COD901608	16	1/2	12	43	55,6	9,5
COD901808	18	1/2	12	45	58	9,5
COD901810	18	5/8	16	45	58	12
COD901812	18	3/4	20	47	58	15
COD902008	20	1/2	12	49	60	9,5
COD902010	20	5/8	16	51	62,6	12
COD902012	20	3/4	20	51	65,3	15
COD902210	22	5/8	16	48	63,5	12
COD902212	22	3/4	20	55	71,7	15
COD902512	25	3/4	20	58	73,5	15
COD902516	25	1"	25	61	73,5	20
COD902816	28	1"	25	68	84	20
COD903016	30	1"	25	76	87	20
COD903520	35	1"1/4	32	76	93	26
COD903820	38	1"1/4	32	83	105	26
COD903824	38	1"1/2	40	89	105	32
COD904224	42		40	108	124	32

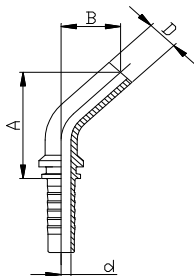
COD45
METRIC SWEPT 45° STANDPIPE, DIN 2353

Artikelcode	Pijpmaat D (mm)	Slangmaat		Afmeting (mm)		
		Inch	mm	A	B	d
COD450603	6	3/16	5	40	18	3
COD450604	6	1/4	6	40	20	4
COD450803	8	3/16	5	46	20	3
COD450804	8	1/4	6	46	20	4
COD450805	8	5/16	8	46	20	5,5
COD451004	10	1/4	6	43	20	4
COD451005	10	5/16	8	43	20	5,5
COD451006	10	3/8	10	43	22	7
COD451204	12	1/4	6	52	24	4
COD451205	12	5/16	8	52	24	5,5
COD451206	12	3/8	10	52	25	7
COD451208	12	1/2	12	52	25	9,5
COD451406	14	3/8	10	52	25	7
COD451408	14	1/2	12	52	31	9,5
COD451506	15	3/8	10	56	24	7
COD451508	15	1/2	12	56	24	9,5
COD451608	16	1/2	12	54	25	9,5
COD451808	18	1/2	12	61	26	9,5
COD451810	18	5/8	16	75	33	12
COD451812	18	3/4	20	62	30	15
COD452008	20	1/2	12	65	40	9,5
COD452010	20	5/8	16	81	40	12
COD452012	20	3/4	20	70	40	15
COD452210	22	5/8	16	77	34	12
COD452212	22	3/4	20	77	34	15
COD452512	25	3/4	20	82	36	15
COD452516	25	1"	25	82	36	20
COD452816	28	1"	25	87	44	20
COD453016	30	1"	25	90	44	20
COD453520	35	1 1/4	32	99	46	26
COD453820	38	1 1/4	32	104	51	26
COD453824	38	1 1/2	40	104	51	32
COD454224	42		40	113	60	32

FM

METRIC FEMALE, 60° CONE

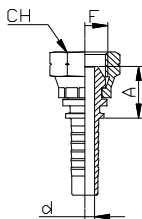

Artikelcode	Draad F	Slangmaat		Afmeting (mm)		
		Inch	mm	CH	A	d
FM1003	10x1	3/16	5	15	16,8	3
FM1004	10x1	1/4	6	15	17	4
FM1203	12x1,5	3/16	5	17	18,2	3
FM1204	12x1,5	1/4	6	17	18,5	4
FM1205	12x1,5	5/16	8			
FM1404	14x1,5	1/4	6	19	18,9	4
FM1405	14x1,5	5/16	8	19	18,9	5,5
FM1406	14x1,5	3/8	10	19	19	7
FM1604	16x1,5	1/4	6	22	20,1	4
FM1605	16x1,5	5/16	8	22	20,1	5,5
FM1606	16x1,5	3/8	10	22	20,2	7
FM1804	18x1,5	1/4	6	24	20,1	4
FM1805	18x1,5	5/16	8	24	20,1	5,5
FM1806	18x1,5	3/8	10	24	20,2	7
FM1808	18x1,5	1/2	12	24	20,7	9,5
FM2006	20x1,5	3/8	10	27	22,4	7
FM2008	20x1,5	1/2	12	27	22,9	9,5
FM2206	22x1,5	3/8	10	27	22,4	7
FM2208	22x1,5	1/2	12	27	22,9	9,5
FM2210	22x1,5	5/8	16	27	22,9	12
FM2610	26x1,5	5/8	16	32	25,4	12
FM2612	26x1,5	3/4	20	32	25,6	15
FM3012	30x1,5	3/4	20	36	26,3	15
FM3016	30x1,5	1"	25			

C90M

METRIC SWEPT 90° FEMALE, 60° CONE

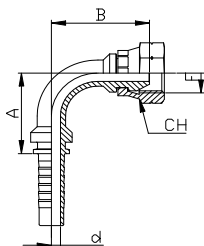

Artikelcode	Draad F	Slangmaat		Afmeting (mm)			
		Inch	mm	CH	A	B	d
C90M1003	10x1	3/16	5	15	23	26	3
C90M1004	10x1	1/4	6	15	22	28	4
C90M1203	12x1,5	3/16	5	17	23	26	3
C90M1204	12x1,5	1/4	6	17	22	28	4
C90M1205	12x1,5	5/16	8				
C90M1404	14x1,5	1/4	6	19	21	30	4
C90M1405	14x1,5	5/16	8	19	28,5	34	5,5
C90M1406	14x1,5	3/8	10	19	28,5	34	7
C90M1604	16x1,5	1/4	6	22	26	32	4
C90M1605	16x1,5	5/16	8	22	32	38	5,5
C90M1606	16x1,5	3/8	10	22	34	38	7
C90M1804	18x1,5	1/4	6	24	26	32	4
C90M1805	18x1,5	5/16	8	24	32	38	5,5
C90M1806	18x1,5	3/8	10	24	34	38	7
C90M1808	18x1,5	1/2	12	24	42	39	9,5
C90M2006	20x1,5	3/8	10	27	33	42	7
C90M2008	20x1,5	1/2	12	27	40	44	9,5
C90M2206	22x1,5	3/8	10	27	33	42	7
C90M2208	22x1,5	1/2	12	27	40	44	9,5
C90M2210	22x1,5	5/8	16	27	43	47	12
C90M2610	26x1,5	5/8	16	32	45	54	12
C90M2612	26x1,5	3/4	20	32	54	59	15
C90M3012	30x1,5	3/4	20	36	54	63	15
C90M3016	30x1,5	1"	25				

C45M

METRIC SWEPT 45° FEMALE, 60° CONE

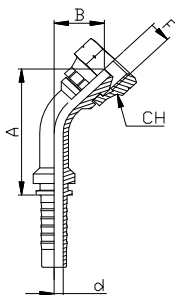

Artikelcode	Draad F	Slangmaat		Afmeting (mm)			
		Inch	mm	CH	A	B	d
C45M1003	10x1	3/16	5	15	38	16	3
C45M1004	10x1	1/4	6	15	42	20	4
C45M1203	12x1,5	3/16	5	17	40	16	3
C45M1204	12x1,5	1/4	6	17	41	20	4
C45M1205	12x1,5	5/16	8				
C45M1404	14x1,5	1/4	6	19	40	16	4
C45M1405	14x1,5	5/16	8	19	40	20	5
C45M1406	14x1,5	3/8	10	19	42	20	7
C45M1604	16x1,5	1/4	6	22	40	18	4
C45M1605	16x1,5	5/16	8	22	51	19	5,5
C45M1606	16x1,5	3/8	10	22	56	19	7
C45M1804	18x1,5	1/4	6	22	40	18	4
C45M1805	18x1,5	5/16	8	22	51	19	5,5
C45M1806	18x1,5	3/8	10	22	56	19	7
C45M1808	18x1,5	1/2	12	22	62	23	9,5
C45M2006	20x1,5	3/8	10	27	50	19,5	7
C45M2008	20x1,5	1/2	12	27	65	25	9,5
C45M2206	22x1,5	3/8	10	27	50	19,5	7
C45M2208	22x1,5	1/2	12	27	65	25	9,5
C45M2210	22x1,5	5/8	16	27	55	31	12
C45M2610	26x1,5	5/8	16	32	68	29	12
C45M2612	26x1,5	3/4	20	32	64	30	15
C45M3012	30x1,5	3/4	20	36	64	35	15
C45M3016	30x1,5	1"	25				

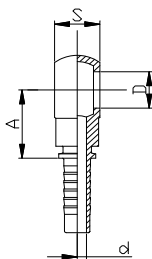
OM
METRIC BANJO

Artikelcode	Banjobout D	Slangmaat		Afmeting (mm)		
		Inch	mm	A	S	d
OM1003	M 10	3/16	5	19,3	10	3
OM1004	M 10	1/4	6	24,2	10	4
OM1203	M 12	3/16	5	22,3	12	3
OM1204	M 12	1/4	6	22,5	12	4
OM1205	M 12	5/16	8			
OM1404	M 14	1/4	6	24,8	14	4
OM1405	M 14	5/16	8	24,5	14	5,5
OM1406	M 14	3/8	10	32,2	14	7
OM1604	M 16	1/4	6	27,2	17	4
OM1605	M 16	5/16	8	26,8	17	5,5
OM1606	M 16	3/8	10	26,8	17	7
OM1804	M 18	1/4	6	28,5	20	4
OM1805	M 18	5/16	8	29,2	20	5,5
OM1806	M 18	3/8	10	28,2	20	7
OM1808	M 18	1/2	12	29,2	20	9,5
OM2006	M 20	3/8	10	29,5	22	7
OM2008	M 20	1/2	12	32,4	22	9,5
OM2206	M 22	3/8	10	27,7	22	7
OM2208	M 22	1/2	12	33,8	22	9,5
OM2210	M 22	5/8	16	30,8	22	12
OM2410	M 24	5/8	16	30,8	26	12
OM2610	M 26	5/8	16	39,3	30	12
OM2612	M 26	3/4	20	37	30	15
OM3012	M 30	3/4	20			
OM3016	M 30	1"	25	44,8	30	20

MM

METRIC MALE, 60° SEAT

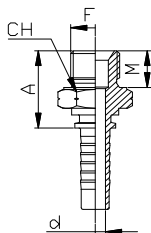

Artikelcode	Draad F	Slangmaat		Afmeting (mm)			
		Inch	mm	CH	A	M	d
MM1003	10x1	3/16	5	15	19,4	8	3
MM1004	10x1	1/4	6	15	19,7	8	4
MM1203	12x1,5	3/16	5	17	24,8	11	3
MM1204	12x1,5	1/4	6	17	25,1	11	4
MM1205	12x1,5	5/16	8				
MM1404	14x1,5	1/4	6	19	26,2	12	4
MM1405	14x1,5	5/16	8	19	26,4	12	5,5
MM1406	14x1,5	3/8	10	19	26,5	12	7
MM1604	16x1,5	1/4	6	22	28,4	13	4
MM1605	16x1,5	5/16	8	22	28,6	13	5,5
MM1606	16x1,5	3/8	10	22	28,7	13	7
MM1804	18x1,5	1/4	6	24	29,4	14	4
MM1805	18x1,5	5/16	8	24	29,6	14	5,5
MM1806	18x1,5	3/8	10	24	29,7	14	7
MM1808	18x1,5	1/2	12	24	30,2	14	9,5
MM2006	20x1,5	3/8	10	27	30,9	14	7
MM2008	20x1,5	1/2	12	27	31,4	14	9,5
MM2206	22x1,5	3/8	10	27	31,9	15	7
MM2208	22x1,5	1/2	12	27	32,4	15	9,5
MM2210	22x1,5	5/8	16	27	32,4	15	12
MM2610	26x1,5	5/8	16	32	34,6	16	12
MM2612	26x1,5	3/4	20	32	35,3	16	15
MM3012	30x1,5	3/4	20	36	36,5	16	15
MM3016	30x1,5	1"	25				

FLPI3

SAE FLANGE 3000 PSI - SAE J518

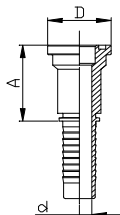

Artikelcode	Flens	Slangmaat		Afmeting (mm)		
		Inch	mm	A	D	d
FLPI30808	1/2	1/2	12	45	30,2	9,5
FLPI31208	3/4	1/2	12	50	38,1	9,5
FLPI31210	3/4	5/8	16	50	38,1	12
FLPI31212	3/4	3/4	20	50	38,1	15
FLPI31612	1"	3/4	20	53	44,5	15
FLPI31616	1"	1"	25	54	44,5	20
FLPI32016	1 1/4	1"	25	57	50,8	20
FLPI32020	1 1/4	1 1/4	32	59	50,8	26
FLPI32420	1 1/2	1 1/4	32	62	60,4	26
FLPI32424	1 1/2	1 1/2	40	62	60,4	32
FLPI33224	2"	1 1/2	40	67	71,4	32
FLPI33232	2"	2"	50	68	71,4	44

Uit een stuk

FLPI6

SAE FLANGE 6000 PSI - SAE J518

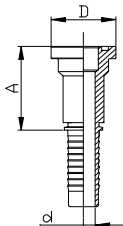

Artikelcode	Flens	Slangmaat		Afmeting (mm)		
		Inch	mm	A	D	d
FLPI60808	1/2	1/2	12	46	31,7	9,5
FLPI61208	3/4	1/2	12	53	41,3	9,5
FLPI61210	3/4	5/8	16	54	41,3	12
FLPI61212	3/4	3/4	20	54	41,3	15
FLPI61612	1"	3/4	20	60	47,6	15
FLPI61616	1"	1"	25	61	47,6	20
FLPI62016	1 1/4	1"	25	68	54	20
FLPI62020	1 1/4	1 1/4	32	70	54	26
FLPI62420	1 1/2	1 1/4	32	76	63,5	26
FLPI62424	1 1/2	1 1/2	40	76	63,5	32
FLPI63224	2"	1 1/2	40	85	79,4	32
FLPI63232	2"	2"	50	85	79,4	44

Uit een stuk

FLPI390

SAE FLANGE 3000 PSI SWEPT 90° - SAE J518

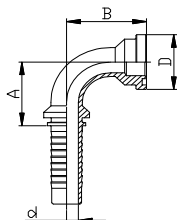

Artikelcode	Flens	Slangmaat		Afmeting (mm)			
		Inch	mm	A	B	D	d
FLPI3900808	1/2	1/2	12	39	39	30,2	9,5
FLPI3901208	3/4	1/2	12	39	44	38,1	9,5
FLPI3901210	3/4	5/8	16	56	53	38,1	12
FLPI3901212	3/4	3/4	20	56	53	38,1	15
FLPI3901612	1"	3/4	20	56	58	44,5	15
FLPI3901616	1"	1"	25	70	65	44,5	20
FLPI3902016	1 1/4	1"	25	70	70	50,8	20
FLPI3902020	1 1/4	1 1/4	32	85	81	50,8	26
FLPI3902420	1 1/2	1 1/4	32	85	85	60	26
FLPI3902424	1 1/2	1 1/2	40	99	92	60,4	32
FLPI3903224	2"	1 1/2	40	99	95	71,5	32
FLPI3903232	2"	2"	50	125	115	71,5	44

Uit een stuk

FLPI690

SAE FLANGE 6000 PSI SWEPT 90° - SAE J518

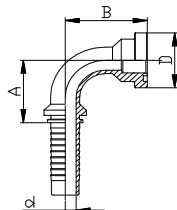

Artikelcode	Flens	Slangmaat		Afmeting (mm)			
		Inch	mm	A	B	D	d
FLPI6900808	1/2	1/2	12	39	39	31,7	9,5
FLPI6901208	3/4	1/2	12	39	43	41,3	9,5
FLPI6901210	3/4	5/8	16	56	57	41,3	12
FLPI6901212	3/4	3/4	20	56	57	41,3	15
FLPI6901612	1"	3/4	20	56	63	47,6	15
FLPI6901616	1"	1"	25	70	70	47,6	20
FLPI6902016	1 1/4	1"	25	70	77	54	20
FLPI6902020	1 1/4	1 1/4	32	85	88	54	26
FLPI6902420	1 1/2	1 1/4	32	85	96	63,5	26
FLPI6902424	1 1/2	1 1/2	40	99	103	63,5	32
FLPI6903224	2"	1 1/2	40	99	116	79,4	32
FLPI6903232	2"	2"	50	125	136	79,4	42

Uit een stuk

FLPI345

SAE FLANGE 3000 PSI SWEPT 45° - SAE J518

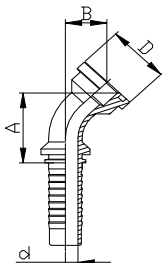

Artikelcode	Flens	Slangmaat		Afmeting (mm)			
		Inch	mm	A	B	D	d
FLPI3450808	1/2	1/2	12	51	22	30,2	9,5
FLPI3451208	3/4	1/2	12	54	25	38,1	9,5
FLPI3451210	3/4	5/8	16	69	27	38,1	12
FLPI3451212	3/4	3/4	20	69	27	38,1	15
FLPI3451612	1"	3/4	20	73	31	44,5	15
FLPI3451616	1"	1"	25	82	33	44,5	20
FLPI3452016	1 1/4	1"	25	86	37	50,8	20
FLPI3452020	1 1/4	1 1/4	32	100	47	50,8	26
FLPI3452420	1 1/2	1 1/4	32	102	49	60,4	26
FLPI3452424	1 1/2	1 1/2	40	111	50	60,4	32
FLPI3453224	2"	1 1/2	40	113	52	71,4	32
FLPI3453232	2"	2"	50	129	56	71,4	44

Uit een stuk

FLPI645

SAE FLANGE 6000 PSI SWEPT 45° - SAE J518

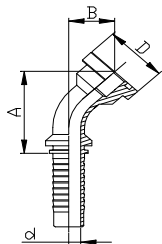

Artikelcode	Flens	Slangmaat		Afmeting (mm)			
		Inch	mm	A	B	D	d
FLPI6450808	1/2	1/2	12	51	22	31,7	9,5
FLPI6451208	3/4	1/2	12	57	28	41,3	9,5
FLPI6451210	3/4	5/8	16	72	30	41,3	12
FLPI6451212	3/4	3/4	20	72	30	41,3	15
FLPI6451612	1"	3/4	20	76	34	47,6	15
FLPI6451616	1"	1"	25	85	36	47,6	20
FLPI6452016	1 1/4	1"	25	90	41	54,0	20
FLPI6452020	1 1/4	1 1/4	32	104	51	54,0	26
FLPI6452420	1 1/2	1 1/4	32	109	56	63,5	26
FLPI6452424	1 1/2	1 1/2	40	118	57	63,5	32
FLPI6453224	2"	1 1/2	40	127	66	79,4	32
FLPI6453232	2"	2"	50	145	71	79,4	44

Uit een stuk

SEM3

SAE SPLIT FLANGE 3000 PSI - SAE J518

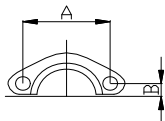

Artikelcode	Flens inch	Diameter Flens mm	Afmeting (mm)	
			A	B
SEM308	1/2	30,2	38,1	8,8
SEM312	3/4	38,1	47,6	11,1
SEM316	1"	44,5	52,4	13,1
SEM320	1*1/4	50,8	58,7	15,1
SEM324	1*1/2	60,4	69,9	17,9
SEM332	2"	71,4	77,8	21,5

SEM6

SAE SPLIT FLANGE 6000 PSI - SAE J518

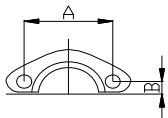

Artikelcode	Flens inch	D. Flangia mm	Afmeting (mm)	
			A	B
SEM608	1/2	31,7	40,5	9,2
SEM612	3/4	41,3	50,8	11,9
SEM616	1"	47,6	57,2	13,9
SEM620	1*1/4	54	66,7	15,7
SEM624	1*1/2	63,5	79,4	18,2
SEM632	2"	79,4	96,8	22,2

FLPIR6

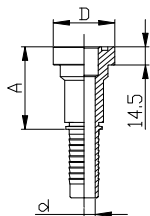

SUPERCAT FLANGE

Artikelcode	Flens	Slangmaat		Afmeting (mm)		
		Inch	mm	A	D	d
FLPIR61212	3/4	3/4	19	59	41,3	15
FLPIR61612	1"	3/4	19	66	47,6	15
FLPIR61616	1"	1"	25	67	47,6	20
FLPIR62016	1*1/4	1"	25	75	54	20
FLPIR62020	1*1/4	1*1/4	32	77	54	26

Uit een stuk

FLPIR690

SUPERCAT FLANGE SWEPT 90°

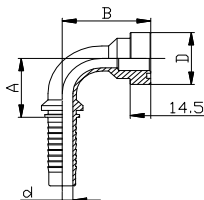

Artikelcode	Flens	Slangmaat		Afmeting (mm)			
		Inch	mm	A	B	D	d
FLPIR6901212	3/4	3/4	19	62	60	41,3	15
FLPIR6901612	1"	3/4	19	62	67	47,6	15
FLPIR6901616	1"	1"	25	74	79	47,6	20
FLPIR6902016	1 1/4	1"	25	74	85	54	20
FLPIR6902020	1 1/4	1 1/4	32	92	94	54	26

Uit een stuk

FLPIR645

SUPERCAT FLANGE SWEPT 45°

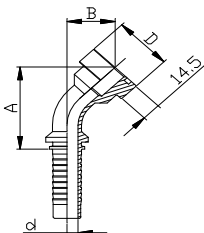

Artikelcode	Flens	Slangmaat		Afmeting (mm)			
		Inch	mm	A	B	D	d
FLPIR6451212	3/4	3/4	19	76	30	41,3	15
FLPIR6451612	1"	3/4	19	82	35	47,6	15
FLPIR6451616	1"	1"	25	95	42	47,6	20
FLPIR6452016	1 1/4	1"	25	100	46	54	20
FLPIR6452020	1 1/4	1 1/4	32	106	52	54	26

Uit een stuk

FORFS

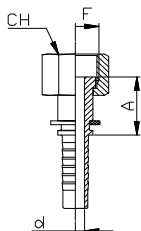

ORFS FEMALE

Artikelcode	Draad F	Slangmaat		Afmeting (mm)		
		Inch	mm	CH	A	d
FORFS1004	9/16-18	1/4	6	17	21,3	4
FORFS1104	11/16-16	1/4	6	22	23,6	4
FORFS1105	11/16-16	5/16	8	22	23,6	5,5
FORFS1106	11/16-16	3/8	10	22	23,7	7
FORFS1306	13/16-16	3/8	10	24	27,2	7
FORFS1308	13/16-16	1/2	12	24	27,7	9,5
FORFS1808	1"-14	1/2	12	30	30,3	9,5
FORFS1810	1"-14	5/8	16	30	30,3	12
FORFS2208	1"3/16-12	1/2	12	36	32,8	9,5
FORFS2210	1"3/16-12	5/8	16	36	32,8	12
FORFS2212	1"3/16-12	3/4	20	36	33	15
FORFS2612	1"7/16-12	3/4	20	41	33,5	15
FORFS2616	1"7/16-12	1"	25	41	34,8	20
FORFS3620	1"11/16-12	1"1/4	32	50	35,3	26
FORFS4624	2"-12	1"1/2	40	60	51,5	32

MORFS

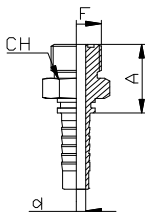

ORFS MALE

Artikelcode	Draad F	Slangmaat		Afmeting (mm)		
		Inch	mm	CH	A	d
MORFS1004	9/16-18	1/4	6	17	27	4
MORFS1104	11/16-16	1/4	6	19	28,2	4
MORFS1105	11/16-16	5/16	8	19	28,2	5,5
MORFS1106	11/16-16	3/8	10	19	28,3	7
MORFS1306	13/16-16	3/8	10	22	31,3	7
MORFS1308	13/16-16	1/2	12	22	31,8	9,5
MORFS1808	1"-14	1/2	12	27	37,3	9,5
MORFS1810	1"-14	5/8	16	27	37,3	12
MORFS1812	1"-14	3/4	20	27	37,5	15
MORFS2208	1"3/16-12	1/2	12	32	39,8	9,5
MORFS2210	1"3/16-12	5/8	16	32	40,3	12
MORFS2212	1"3/16-12	3/4	20	32	40,5	15
MORFS2612	1"7/16-12	3/4	20	41	45	15
MORFS2616	1"7/16-12	1"	25	41	46,3	20
MORFS3620	1"11/16-12	1"1/4	32	46	48,9	26
MORFS4624	2"-12	1"1/2	40	55	53,8	32

C90ORFS

ORFS SWEPT 90° FEMALE

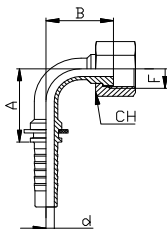

Artikelcode	Draad F	Slangmaat		Afmeting (mm)			
		Inch	mm	CH	A	B	d
C90ORFS1004	9/16-18	1/4	6	17	29	26	4
C90ORFS1104	11/16-16	1/4	6	22	29	28	4
C90ORFS1105	11/16-16	5/16	8	22	30	28	5,5
C90ORFS1106	11/16-16	3/8	10	22	35	29	7
C90ORFS1306	13/16-16	3/8	10	24	35	32	7
C90ORFS1308	13/16-16	1/2	12	24	39	37	9,5
C90ORFS1808	1"-14	1/2	12	30	40	37	9,5
C90ORFS1810	1"-14	5/8	16	30	54	44	12
C90ORFS2208	1"3/16-12	1/2	12	36	41	42	9,5
C90ORFS2210	1"3/16-12	5/8	16	36	45	47	12
C90ORFS2212	1"3/16-12	3/4	20	36	51	53	15
C90ORFS2612	1"7/16-12	3/4	20	41	58	54	15
C90ORFS2616	1"7/16-12	1"	25	41	74	68	20
C90ORFS3620	1"11/16-12	1"1/4	32	50	90	74	26
C90ORFS4624	2"-12	1"1/2	40	60	108	95	32

C45ORFS

ORFS SWEPT 45° FEMALE

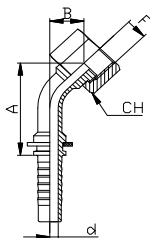

Artikelcode	Draad F	Slangmaat		Afmeting (mm)			
		Inch	mm	CH	A	B	d
C45ORFS1004	9/16-18	1/4	6	17	44	11	4
C45ORFS1104	11/16-16	1/4	6	22	44	11	4
C45ORFS1105	11/16-16	5/16	8	22	45	11	5,5
C45ORFS1106	11/16-16	3/8	10	22	51	11	7
C45ORFS1306	13/16-16	3/8	10	24	55	13	7
C45ORFS1308	13/16-16	1/2	12	24	60	14	9,5
C45ORFS1808	1"-14	1/2	12	30	62	15	9,5
C45ORFS1810	1"-14	5/8	16	30	74	19	12
C45ORFS2208	1"3/16-12	1/2	12	36	62	24	9,5
C45ORFS2210	1"3/16-12	5/8	16	36	75	23	12
C45ORFS2212	1"3/16-12	3/4	20	36	88	29	15
C45ORFS2612	1"7/16-12	3/4	20	41	86	32	15
C45ORFS2616	1"7/16-12	1"	25	41	97	32	20
C45ORFS3620	1"11/16-12	1"1/4	32	50	107	35	26
C45ORFS4624	2"-12	1"1/2	40	60	140	45	32

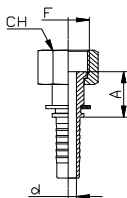
FW
CO² FEMALE WHITWORTH THREAD

Artikelcode	Draad F	Slangmaat		Afmeting (mm)		
		Inch	mm	CH	A	d
FW21706	21,7	3/8	9,5	27	18,6	7
FW21708	21,7	1/2	12,7	27	18,6	9,5

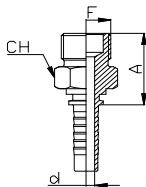
MW
CO² MALE WHITWORTH THREAD

Artikelcode	Draad F	Slangmaat		Afmeting (mm)		
		Inch	mm	CH	A	d
MW21706	21,7	3/8	9,5	24	27	7
MW21708	21,7	1/2	12,7	24	27	9,5

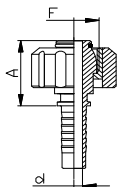
FMK
PRESSURE WASH FEMALE "K"

Artikelcode	Draad F	Slangmaat		Afmeting (mm)	
		Inch	mm	A	d
FMK2204	22x1,5	1/4	6	30,7	4
FMK2205	22x1,5	5/16	8	30,7	5,5
FMK2206	22x1,5	3/8	10	30,7	7

GPG

DOUBLE CONNECTOR

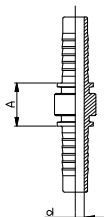

Artikelcode	Slangmaat		Afmeting (mm)	
	Inch	mm	A	d
GPG0303	3/16	5	17	3
GPG0404	1/4	6	17	4
GPG0505	5/16	8	17	6
GPG0606	3/8	10	17	7
GPG0808	1/2	12	18	10
GPG1010	5/8	16	18	12
GPG1212	3/4	20	19	15
GPG1616	1"	25	21	20
GPG2020	1 1/4"	32	24	26

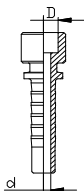
RS
WELDING INSERT

Artikelcode	Slangmaat		Afmeting (mm)	
	Inch	mm	D	d
RS0406	1/4	6	6	4
RS0408	1/4	6	8	4
RS0410	1/4	6	10	4
RS0510	5/16	8	10	5,5
RS0512	5/16	8	12	5,5
RS0610	3/8	10	10	7
RS0612	3/8	10	12	7
RS0614	3/8	10	14	7
RS0814	1/2	12	14	9,5
RS0815	1/2	12	15	9,5
RS0816	1/2	12	16	9,5
RS1018	5/8	16	18	12
RS1220	3/4	20	20	15
RS1222	3/4	20	22	15
RS1626	1"	25	26	20
RS2032	1 1/4	32	32	26
RS2438	1 1/2	40	38	32
RS3250	2"	50	50	44

